

GET WASTE WISE!

2024

The Omrin Afvalapp

All your waste sorting at a glance.

Household and communal waste bins

What bins do you have at home?
When do you put your bins out for collection?
Everything you need to know.

Get waste wise!

A 20-page guide to better
waste sorting.

Have you still got it?



The Waste Wise Guide is published by



“All my waste sorting at a glance.”

Want to quickly find out your waste collection day?

Download the Omrin waste app.
It will send a helpful reminder.



Scan with your phone



What can you pass on?

If things can be reused, don't throw them out, pass them on!
Donate them to an Omrin Estafette recycling shop.

Recycle Boulevard Leeuwarden

Voltastraat 11 in Leeuwarden
Open Monday to Saturday:
10.00 - 17.00

You can return your items in 3 ways:

1. At the Recycle Boulevard
2. In the Estafette container on our Environmental Streets in Grou, Leeuwarden and Stiens
3. Have items picked up at home.

www.estafetterecyclewinkels.nl

Follow us on:



STICHTING OMRIN
ESTAFETTE

Contents

02 The Omrin waste app, sort all your waste quickly and easily!
Omrin Estafette recycling shops.
What can you pass on?

04 All sorted in Leeuwarden.
The new waste policy

05 Household and communal waste bins
- When do you put your bins out for collection?
- Your nearest communal bins
- How do you dispose of hazardous waste?

07 What goes where?
- Mixed recyclables and residual waste
- Organic waste and leftovers
- Recyclable paper and card
- Glass
- Textiles

13 Taking waste to the Milieustraat
Always take your Milieupas card!
What can you take to the Milieustraat?

14 Book a time slot
Where to find our recycling centres (milieustraat)

15 Borrow a trailer or cargo bike for free
Milieustraat fees

16 Are you unable to deliver items yourself?
We are happy to collect large items, garden waste, electrical appliances and items and textiles for Estafette from your home

17 What do you do with plastic, cans and drink cartons?
Put them in your bin for mixed recyclables or the refuse container!

18 Four tips on how to generate less waste and save money

19 What's your waste rating?
Let's recycle together!



04



07

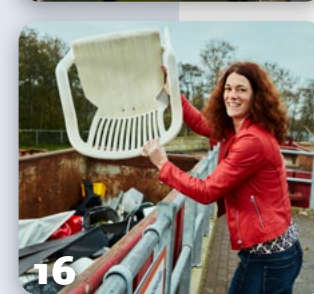

16

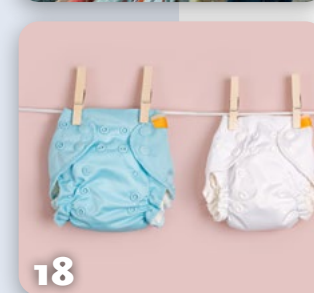

18



All sorted in Leeuwarden

On 1 January 2022, the municipality of Leeuwarden launched a new waste policy with the slogan 'All sorted in Leeuwarden'. On 1 January 2023, we started separating waste as carefully as possible. You now pay a fixed amount and a variable amount. You pay less if you carefully separate your waste and put less waste out for collection. It's better for the environment.

In the Netherlands, we incinerate non-recyclable waste. The cost of doing this is rapidly increasing. So, we ask you to reduce the amount of waste you produce, and to separate recyclable

items as carefully as possible and take large items to the Milieustraat. Things can then be more effectively reused, you will produce less waste and we will have less waste to incinerate.

Want to know how much waste you produce?

Download the Omrin waste app and create an account. The app will show you how much waste you have put out for collection. Find out more about 'All sorted in Leeuwarden' at <https://www.leeuwarden.nl/afval-en-recycling/>

How we calculate the variable amount:

As of 1 January 2023, you pay a fixed amount each year plus a variable amount based on your use. The variable amount depends on how much waste you put out for collection.



Mixed recyclables bin (grey 'Sortibak' bin) 2024
€ 1,- to empty +
€ 0,09 per kilo of waste



Communal waste bin 2024
€ 0,67 per bag = per bin deposit



If you live in the municipality of Leeuwarden, you can put your waste in wheelie bins issued to your household or communal waste bins in your neighbourhood. Large items can be taken to the Milieustraat. For this, you need your Milieupas card.

What bins do you have at home?

At home you have a 'Sortibak' for mixed recyclables and a 'Biobak' for organic waste. Some households also have a 'Papierbak' for recyclable paper and card. For those who live in apartments and in the centre of Leeuwarden there are communal waste bins. What goes where? You can find out what goes in each bin from page 8 onwards. Each household also has a red box for safe storage of hazardous waste. In the Netherlands, this type of waste is known as 'KCA', which stands for 'small chemical waste'.

When do you put your bins out for collection?

The annual waste collection calendar is issued to each household. You can also download it at www.omrin.nl. Please put your bin out for collection before 7:30 am. If you live in the centre of Leeuwarden, put it out before 8:00 am.

Please note! If your bin contains waste that does not belong in it, it will not be emptied. And bags placed next to the bin will not be collected. Bins may only be put out on the street the day they are emptied. Please remove your bins from the street the same day.

If your bin or Milieupas card is lost or doesn't work or if you are moving home

The bins and Milieupas card belong to Omrin. They are issued on loan to the resident(s) of the property. Be sure to leave them at the property when you move out. If one of your bins or your Milieupas card is lost or doesn't work, please contact Omrin. The bins are equipped with a chip. This is how the waste collection truck identifies your bin. This prevents it from being used if it is stolen, for example. If you would like a second bin for mixed recyclables, organic waste or recyclable paper and card, please call Omrin on 0900 210 0215.

Communal waste bins near you

For those who live in apartments and in the centre of Leeuwarden there are communal waste bins for refuse and organic waste (fruit, vegetable and garden waste and leftovers) nearby. You can open communal bins for refuse and organic waste with your Milieupas card. What if the bin is full or doesn't work? No problem! You are allocated at least two bins near your home. If one doesn't work, there is always another one you can use. Please note! If you leave waste

next to the bin, you may be fined for illegal dumping! There are also communal waste bins for recyclable paper and card, glass and textiles. With the Omrin waste app, you can quickly find a communal waste bin for recyclable paper and card, glass and textiles near you!

What about hazardous waste (KCA)?

In the Netherlands, hazardous waste is referred to as 'KCA', which stands for 'small chemical waste'. It contains harmful substances. Store hazardous waste safely. Put it in your red box for hazardous waste or keep it in the original packaging and put it out for collection separately. It will be collected by the Chemokar truck on one of its rounds. This FREE service makes it very easy to dispose of your hazardous waste. The Chemokar also collects small electrical appliances such as a broken hairdryer or electric toothbrush. If you miss the Chemokar, you can find the next collection date for your street on the flyer posted through your letterbox or on our website: www.omrin.nl/inzamelingkca. You can also take hazardous waste to the Milieustraat for free disposal.

Check the Omrin waste app, go to www.omrin.nl or call Omrin on 0900 210 0215



The right way to put your bins out for collection! →

What goes where?

You put mixed recyclables, organic waste and recyclable paper and card in your wheelie bins. If you live in an apartment or in the centre of Leeuwarden there are communal waste bins for organic waste and refuse nearby. There are also communal waste bins for recyclable paper and card, glass and textiles. With the Omrin waste app, you can quickly find a communal waste bin for recyclable paper and card, glass and textiles near you!

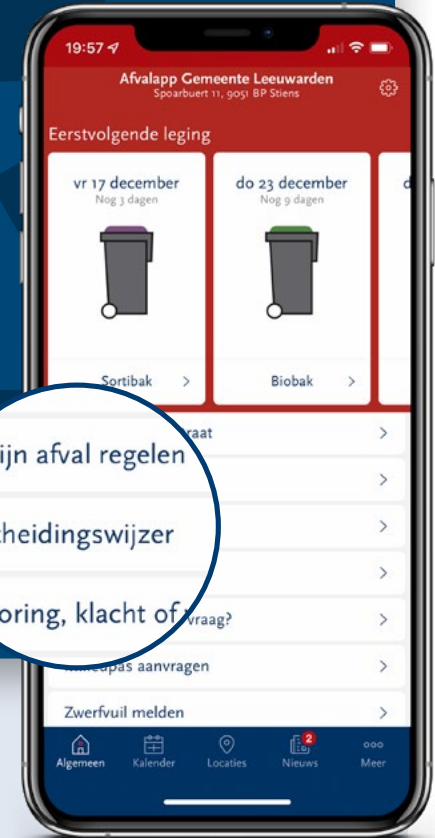

You sort it, we do the rest!

To help us maximise resource recovery from waste it is important that you sort your waste and put it in the right bins. Then we can make sure your waste is given a second life.

Find out more

Download the Omrin waste app. Includes a handy waste sorting guide.



Scan with your phone



MIXED RECYCLABLES AND RESIDUAL WASTE



What goes in the 'Sortibak' bin for mixed recyclables and refuse so most of it can be reused?



Plastic



Cans



Cartons



Refuse*

* Non-separable waste, such as crisp packets, cat litter and full vacuum cleaner bags.



What does **NOT** go in the 'Sortibak' bin for mixed recyclables and residual waste?



Organic waste & leftovers



Paper & cardboard



Glass



Textiles



Deep-frying oil



Electrical appliances



Hazardous waste



Large items



Construction & demolition waste



ORGANIC WASTE AND LEFTOVERS



What goes in your household or communal bin for organic waste?



leftovers



small garden waste



rodent poop



These do **NOT** go in the organic waste bin but are treated as residual waste:



non-biodegradable waste



cat litter



bags of dog poop



deep-frying oil
Take this to the Milieustraat or your local supermarket



PAPER AND CARDBOARD



What goes in your household or communal bin for recyclable paper and cardboard?



The following items are **NOT** recyclable but are treated as residual waste:



GLASS



What goes in the glass container? No need to rinse or remove the lid!



These do **NOT** go in the glass container but are treated as residual waste:





TEXTILES



What goes in the textiles container?



clothing, may be worn or torn



pairs of shoes tied together



sheets and blankets



curtains



towels



soft toys

These do **NOT** go in the textiles container but are treated as residual waste:



textiles that are wet or stained with oil or paint



mattresses



duvets



pillows



carpet



knitting wool



Taking waste to the Milieustraat

If you have waste that does not belong in your household or communal bins for mixed recyclables and residual waste or organic waste, take it to the Milieustraat. Here we separate the waste so it can be reused.

What can you take to the Milieustraat?

- Electrical appliances
- Large items such as sofas, cabinets and carpets
- Construction and demolition waste such as laminate, plaster and wood
- Large garden waste
- Hazardous waste (KCA)
- Hard plastics
- Deep-frying oil
- Mattresses
- Styrofoam
- Car tyres

View the full list at www.omrin.nl/milieustraat

Always take your Milieupas card when you go to the Milieustraat!



If you can't get to the Milieustraat, we can arrange to come and collect large items, large garden waste and large electrical appliances. See page 16 for details.

Tip from Paul:

"If things you are throwing out can be reused or repurposed, take them to the Milieustraat and put them in the container for Omrin Estafette recycling shops."



Taking waste to the Milieustraat?

Book a time slot!

To take waste to the recycling centre in Leeuwarden, Stiens or Grou, you need to book a time slot. In other words, to visit our recycling centres, you need to make an appointment. This prevents long queues and helps you separate your waste more quickly.

How it works

- ✓ Book a time slot in the Omrin waste app or www.omrin.nl or call Omrin: 0900 – 210 0215
- ✓ Choose a day and time that suits you
- ✓ No need to wait in line
- ✓ Easily sorted

Don't forget to take your Milieupas card!!



Omrin recycling centres in the municipality of Leeuwarden:

milieustraat Leeuwarden	milieustraat Grou	milieustraat Stiens
Greunsweg 86, Leeuwarden	Oedsmawei 9, Grou	Seerob 23, Stiens
Open	Open	Open
Monday to Friday: 09.00 - 16.30	Monday to Friday: 09.00 - 16.30	Monday to Friday: 13.00 - 16.30
Saturday: 09.00 - 17.30	Saturday: 08:30 uur - 11.30	Saturday: 09.00 uur - 13.00

You can also take your waste to other recycling centres.

Please note! You always pay the fees that apply in your own municipality.

Fees

Sometimes you have to pay to take waste to the Milieustraat. This applies to things such as construction and demolition waste, car tyres and certain batteries. Unsorted waste will be accepted twice free of charge. Carefully sorted bulky waste is always accepted free of charge. For full details of current rates and conditions, go to www.omrin.nl/milieustraat, call Omrin on 0900 210 0215 or ask one of the staff at the Milieustraat.

**PIN
YES PLEASE**

Borrow a trailer or cargo bike for free

At the recycling centres in Leeuwarden, Stiens and Grou you can borrow a trailer for free. And in Leeuwarden we even have a cargo bike. So it's easy to take your waste to the Milieustraat.

To borrow the trailer or cargo bike

Call Omrin on 0900 210 0215. After paying a cash deposit of €100.00 for the trailer or €50.00 for the cargo bike, you will be given the vehicle for a morning or afternoon.



Are you unable to deliver items yourself?

We can arrange to come and collect large items, large garden waste and large electrical appliances. Book a collection through the [Omrin Afvalapp](#), at www.omrin.nl or call Omrin on 0900 210 0215.

Large items

We will come and collect large items twice a year FREE of charge on our scheduled days. This service must be booked in advance. For collection of large items more than twice a year or on a non-scheduled day, there is a charge of €62.00 per visit. The collection must always be booked in advance. You can do this through the Omrin waste app or at www.omrin.nl and pay easily with iDEAL. Or you can call Omrin on 0900 210 0215.

Spullen en textiel voor Estafette

How nice that you think of Estafette to donate your textiles and reusable items! We will collect them from your home for free if you cannot bring them yourself. Make an appointment via the Omrin Afvalapp, www.estafetterecyclewinkels.nl or call Estafette Recycle Boulevard Leeuwarden: 058 234 76 00.

Please note!

- ✓ Collection of large items, large garden waste and large electrical appliances must always be booked in advance!
- ✓ If you put waste out for collection without booking in advance, you may be fined for illegal dumping!
- ✓ Large items and large garden waste put out for collection must not exceed 1 m³!
- ✓ We do not collect construction and demolition waste, such as laminate, plaster and wood. These must be taken to the Milieustraat!

Plastic? Let's extract as much of it as we can!

What do you do with plastic, cans and drink cartons?

Put them in your household or communal bin for mixed recyclables and residual waste!



When you put recyclable paper, glass, textiles and organic waste in the right bins, it is given a second life! You can put plastic, cans, drink cartons and diapers in the bin for mixed residual waste. Our high-tech machines separate out waste of different types and sizes. It can then be recycled as efficiently as possible.

We pass on reusable materials to the processing industry so they can be converted into new products. For instance, we turn recycled plastic into new waste containers.



From the organic waste in nappies we produce biogas. Almost all of our trucks run on our biogas. The rest goes into the national grid. Two inspiring examples of circular economy.



*Interested to know how we do this?
Find out at Omrin.nl or follow us on:*



Four tips on how to generate less waste and save money

We all want a world with less waste. But what are smart ways to do it? You always carry a bag with you for your shopping and carefully separate your waste. And there are other simple ways to reduce your waste.

1. Need something new?

Why not see if you can get it second-hand? Maybe from an Omrin Estafette recycling shop or Kringloop Grou. Something someone else no longer needs will often feel as good as new to you

2. Borrow from your neighbours!

How often do you use a drill, hedge trimmer or party tent? Start an app group with your neighbours so you can borrow from each other. There are lots of things we only use once a year. This way you won't have to buy a new one, nor will your neighbours. Twice as sustainable!

3. Packaging? Do away with it!

Buy unpackaged things from the recycling shop and pick up your groceries at the market. Makes a huge difference in terms of waste. And buy products that genuinely reduce waste, such as reusable nappies, laundry soap nuts, toothpaste tablets and shampoo bars.



4. Reusable nappies

- Eliminate over 1,500 kilos of waste per child.
- Save up to €800.- per child.
- Always one in the cupboard so you never run out.



What's your waste rating?

The Omrin waste app will show you exactly how much waste you produce. If you have a household bin for mixed recyclables, our waste label will show your rating. Just like an energy label.

If you use an underground container communal bin near your home, we compare what you deposit in the bin with a reference household. Again you can see your rating!

So download the Omrin waste app. Create an account and check your rating!
www.omrin.nl/afvalapp



Damaged sock? Perfect for recycling!

1



Collect worn textiles in a plastic bag

2



Seal the bag tightly so that it is waterproof

3



Take the bag to the textile bin in your neighbourhood.



Worn out or damaged, still full of value!





2024.13

“Working together to create a cleaner and more sustainable world”

Omrin

Hidalgoweg 5 in Leeuwarden

Phone: 0900 - 210 0 215

www.omrin.nl

